

NATIONAL CENTRE FOR CATALYSIS RESEARCH

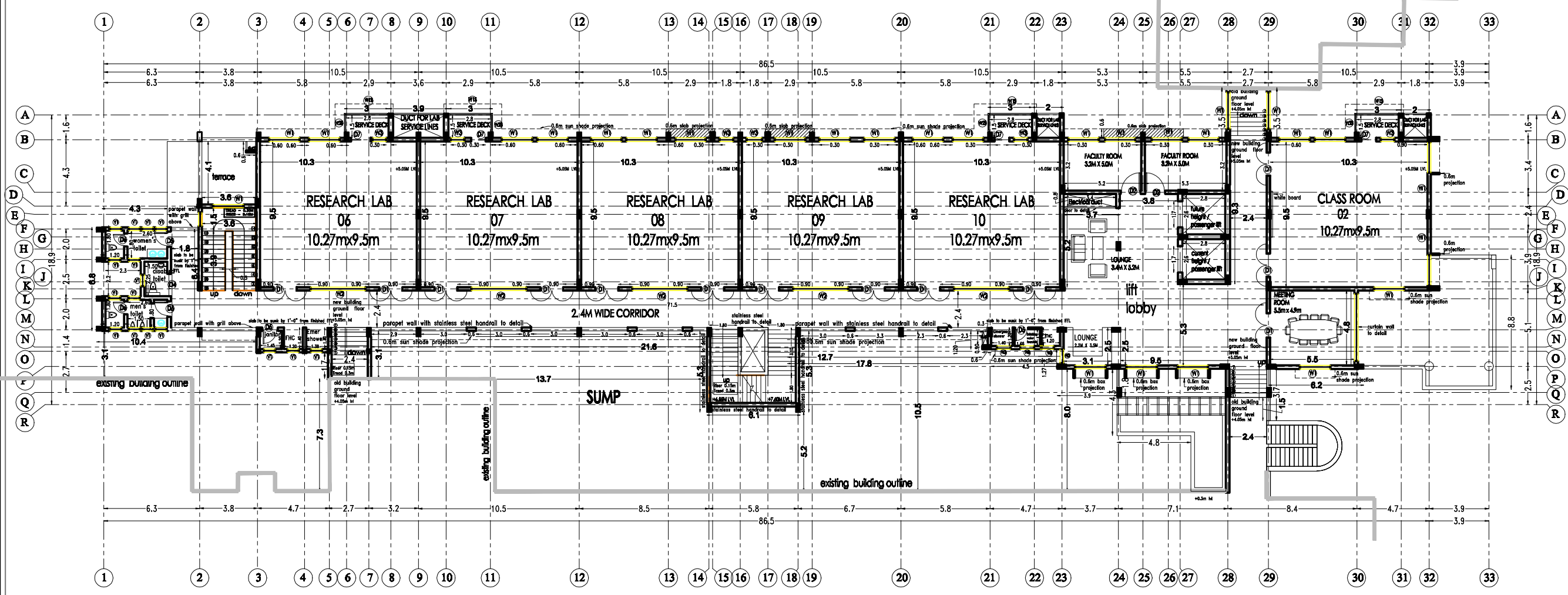

FIRST FLOOR PLAN

SCHEDULE OF OPENINGS

| INITIATION | DESCRIPTION | WIDTH | HEIGHT |
|------------|--|---------|---------|
| FD | Fire door + ventilator fixed with grill | 1.50 m. | 2.10 m. |
| D1 | Teak wood frame with commercial ply flushed door with paint finish with vision panel | 1.50 m. | 2.10 m. |
| D2 | Teak wood frame with commercial ply flushed door with veneer finish with small vision panel | 1.20 m. | 2.10 m. |
| D3 | Teak wood frame with commercial ply flushed door with paint finish | 1.20 m. | 2.10 m. |
| D4 | Aluminium Sliding door with commercial ply flushed shutter with center style for disabled toilet | 1.20 m. | 2.10 m. |
| D5 | Teak wood frame commercial ply flushed door with paint finish | 1.00 m. | 2.10 m. |
| D6 | Teak wood frame with solid core PVC door | 0.75 m. | 2.10 m. |
| D7 | Aluminium Glazed door | 2.00 m. | 2.10 m. |
| D8 | Pressed steel frame with MS GRILL shutter to be placed in front of all terrace doors | 1.50 m. | 2.10 m. |
| W1 | Aluminium window with Saint Gobain SGG Reflectoal glazing with MS square grill + ventilator with grill | 2.00 m. | 1.50 m. |
| W2 | Aluminium window with Saint Gobain SGG Reflectoal glazing with MS square grill + ventilator with grill | 3.60 m. | 1.50 m. |
| W3 | Aluminium window with Saint Gobain SGG Reflectoal glazing with MS square grill | 0.90 m. | 1.50 m. |
| W1S | Aluminium window with Saint Gobain SGG Reflectoal glazing with MS square grill | 2.40 m. | 1.50 m. |
| W2S | Aluminium window with Saint Gobain SGG Reflectoal glazing with MS square grill | 0.60 m. | 1.50 m. |
| V1 | Standard steel ventilator with louvers + MS square grill | 0.75 m. | 0.90 m. |

AREA STATEMENT

| | |
|----------------------|----------------------------------|
| GROUND FLOOR AREA | 1259SQM(13552 SQFT) |
| FIRST FLOOR AREA | 1180SQM(12701 SQFT) |
| SECOND FLOOR AREA | 1180SQM(12701 SQFT) |
| TOTAL AREA | 3619SQM(38954 SQFT) |
| NUMBER OF FLOORS-G+2 | NUMBER OF CLASS ROOMS-3 |
| NUMBER OF LABS-15 | ADDITIONAL AREA-769SQM(8277SQFT) |

ROOM FINISH SCHEDULE

| DESCRIPTION | FLOOR | WALLS |
|---------------|--|------------------------|
| CORRIDOR | Kota with marble | Semigloss enamel paint |
| LOBBY | Kota with marble | Semigloss enamel paint |
| LABS | Acid proof ceramic tiles Johnson 12mm thick andura Industrial tile with 3mm epoxy mortar joints. | Semigloss enamel paint |
| LAB TRENCHES | Acid proof ceramic tiles Johnson 12mm thick andura Industrial tile with 3mm epoxy mortar joints. | Acid proof tiles |
| FACULTY ROOMS | Kota slab with granite border | 12MM Granite tiles |
| TOILETS | 300mm x 300mm rectified ceramic tiles | 8x12" ceramic tiles |

APPROVAL

Blank area for approval signature and stamp.

TENDER

Blank area for tender signature and stamp.

PROJECT

PROPOSED NEW BUILDING FOR CHEMISTRY DEPARTMENT

- DRAWING TO BE READ AND NOT MEASURED.
- ALL DIMENSIONS TO BE CHECKED ON SITE BEFORE ANY CONSTRUCTION.
- ALL DIMENSIONS ARE IN METRES.

DRAWING STATUS

SCHEME FOR APPROVAL
 TENDER DRAWING
 ADVANCE COPY
 G.F.C.

ARCHITECT

ARCHESTUDIO CHENNAI PRIVATE LIMITED
 NO.15, A1 NETHRAMBAGI APARTMENT'S
 VEMBULIANMAN KOIL STREET,
 WEST 104 NAGAR, CHENNAI - 600 078.
 C: 044-42191409
 email: archstudio@gmail.com

NAME OF DRAWING

FIRST FLOOR PLAN

DRAWING NO. 102-R22

DATE OF SUBMISSION 12-11-12

SCALE NOT TO SCALE